

## GW-42 Multi Grip Stainless Steel 304 Rivet

Countersunk head · Stainless steel 304 body · Stainless steel 304 stem · Multi-grip  
3.2 mm (1/8") - 4.8 mm (3/16")

### Features

- Multi-grip capability accommodates wide variations in material thickness
- Good hole fill provides strong, vibration resistant joints
- Compensates for irregular, oversized, slotted or misaligned holes
- Can stop sheet movement in non-standard holes
- Retained stem avoids damage, electrical problems or rattling caused by loose stems

### Material

- Body: Stainless steel 304, polished
- Stem: Stainless steel 304, polished

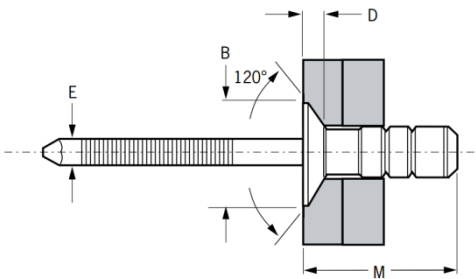

Before Placement

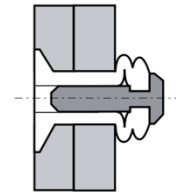

After Placement

Part No.	Size ø	Grip Range		Hole Size		M	øB	D	øE	Shear (typical) kN	Tension (typical) kN
		min.	max.	min.	max.						
GW42-0412	3.2 (1/8")	1.6	6.4	3.3	3.4	13.8	5.63	0.98	2.26	1.85	2.05
GW42-0618	4.8 (3/16")	1.5	9.0	4.9	5.0	17.8	8.80	1.60	3.00	3.43	4.10



### Can't find what you are looking for?

We can provide customized finishing and colouring.  
Contact your nearest [Gripwell](http://www.gripwell.com) team for assistance!